

COMUNE DI MESSINA

PROGETTO PER LA CONSERVAZIONE, FRUIZIONE E GESTIONE DEL SITO "MONASTERO SANTA MARIA DI GESU' SUPERIORE - PRESUNTA SEPOLTURA ANTONELLO DA MESSINA" LOCALITA' VIALE GIOSTRA (ME)

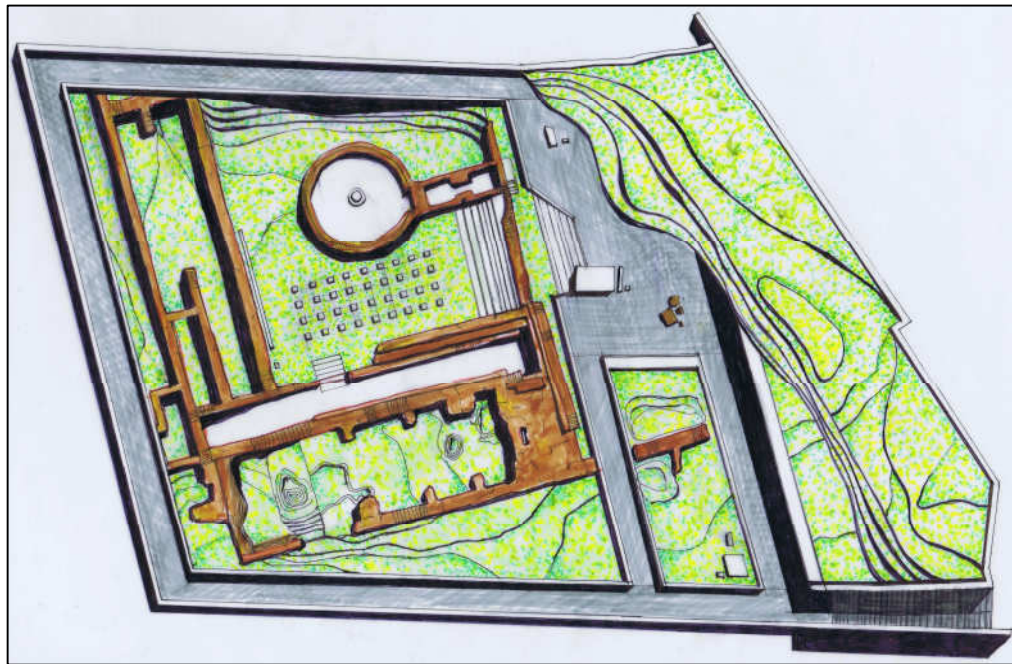

RENDERING

TAV. 03

GRUPPO DI PROGETTAZIONE
Arch. Giuseppina Vinci

con Ing. Sebastiano Mazzeo

Collaboratore
Arch. Maria Teresa Fucile

Geom. Girolamo Giglio

Arch. Mauro Scarcella Perino

Consulente Marketing:
Dott.ssa Francesca Mangano

COMMITTENTE
Ente Gestore:
Società Cooperativa Sociale Onlus "TRAPPER"

Ente Proprietario:
Parrocchia S. Maria di Gesù Superiore

DATA : 22 Luglio 2013

Arch. Giuseppina Vinci con studio in Messina, Viale Principe Umberto C.da Castellaccio n. 49 - complesso "Le Terrazze 2" 98122 Messina
Tel. - Fax 090.671816 mobile 333.3042387 - e.mail: giusyvinci@hotmail.com

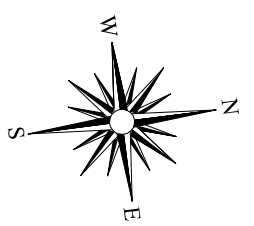
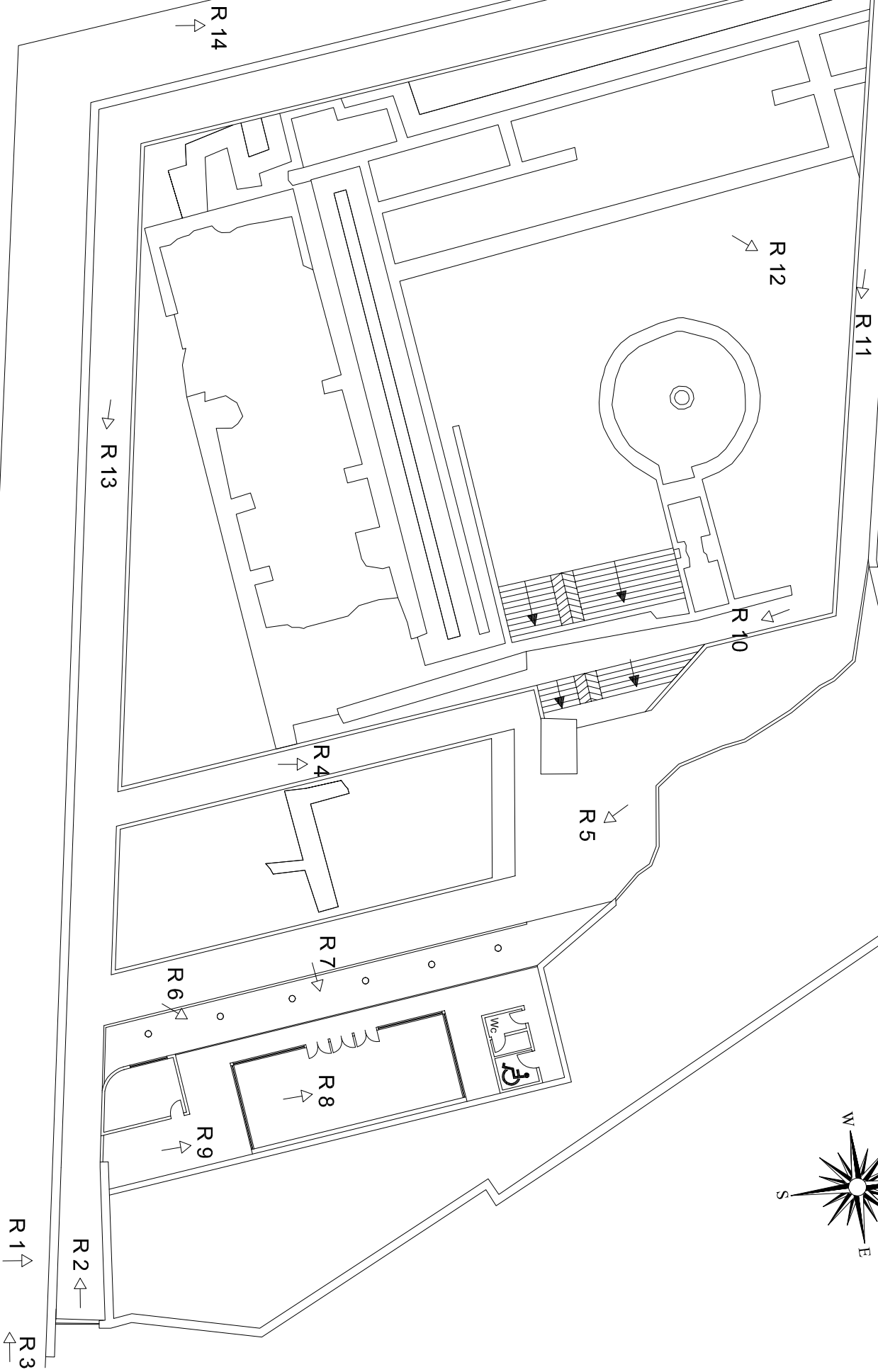









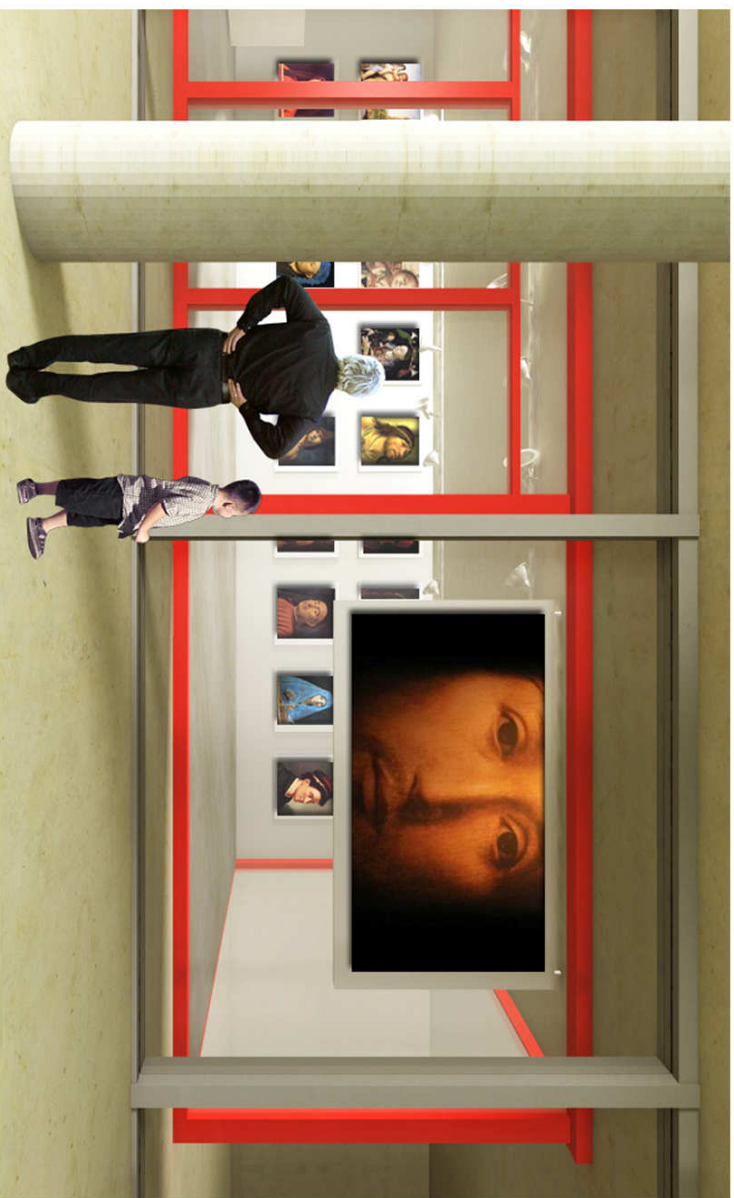

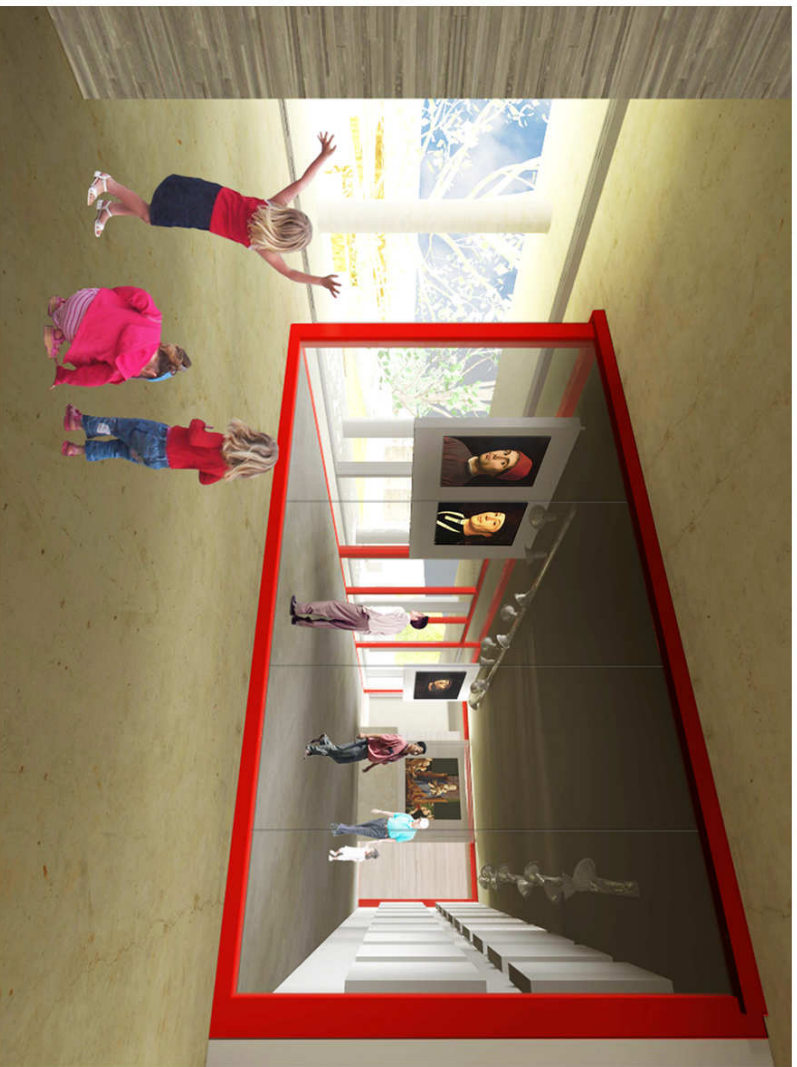
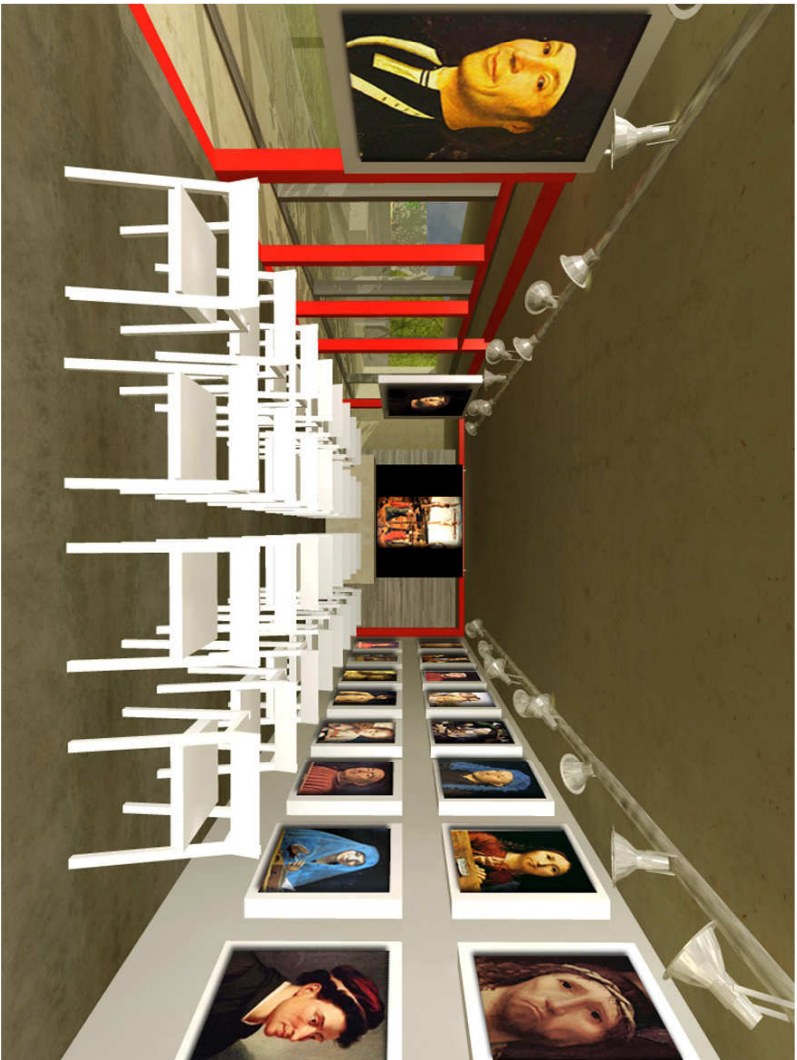









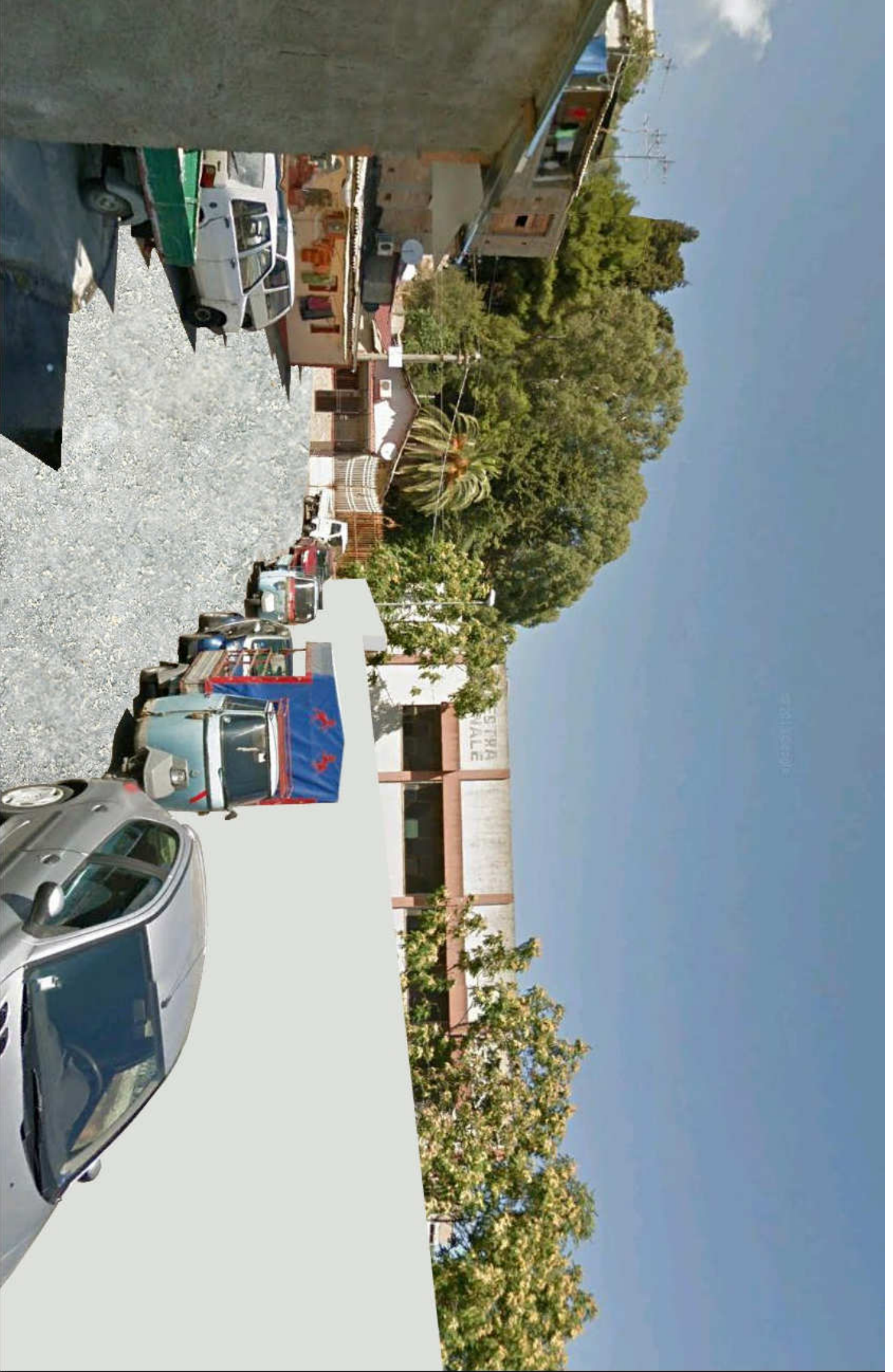

ESTRADA SALE